

ALBA

AU1053+1096



JF Sevilla
Design 2018

EN

| | |
|-----------------------|--|
| MATERIALS | Steel / Alabaster |
| FINISHES | Metal Shiny Gold Chrome Black |
| SPECIFICATIONS | E26 Max. 15W (Not included) 110-120 V, 50/60 Hz |
| ENERGY LABEL | E |
| BULB IMAGE | B038/ORO |
| DISC SIZE | 9.84" - 13.78" |

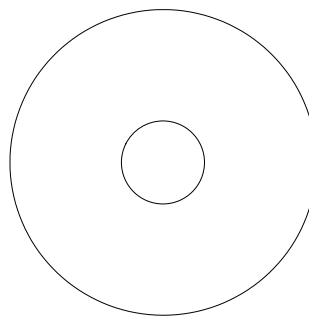

Ø9.84" / Ø13.78"

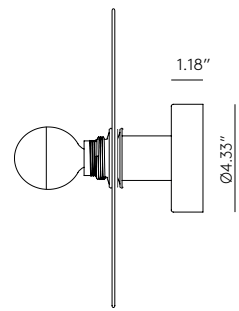

1.97"

ICONS



* Alabaster: being a natural stone, it may differ in tone, veins, translucency.